

| Rev No | Alteration | Date | Checked | Approved |
|--------|--------------|------------|---------|----------|
| 13 | ADDED NOTE 1 | 2016-03-02 | INJRJ | PDM |

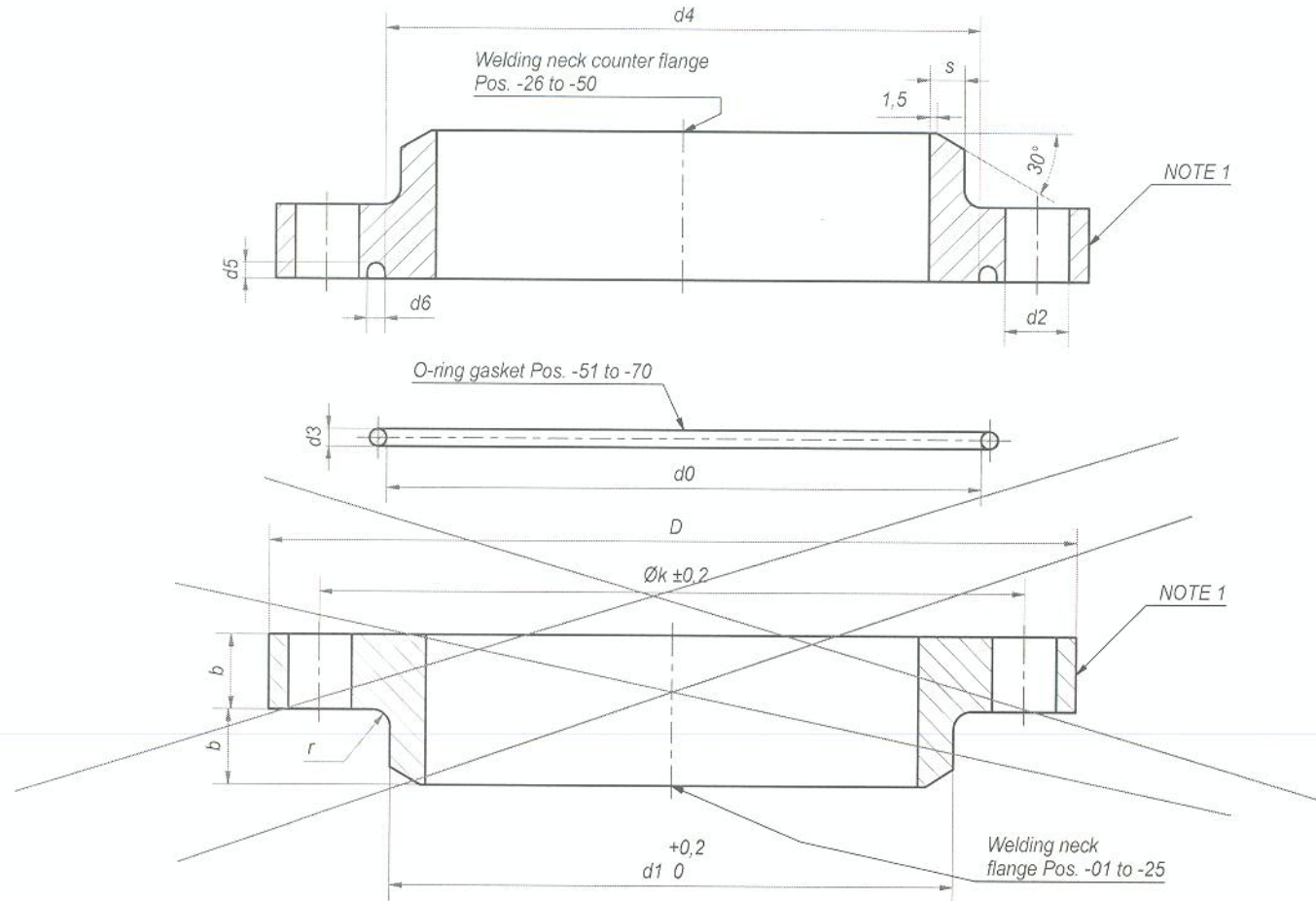

| Pos. | DN | PN | d1 | D | b | k | s | r | d0 | d2 | d3 | No of holes |
|------|-------|--------|--------|--------|-------|--------|------|------|--------|-------|------|-------------|
| -01 | DN100 | 6-40 | 114,30 | 165,00 | 15,00 | 144,00 | 3,60 | 3,60 | 120,25 | 13,00 | 3,53 | 12 |
| -02 | DN80 | 6-40 | 88,90 | 141,00 | 15,00 | 118,00 | 3,20 | 3,20 | 94,80 | 13,00 | 3,53 | 8 |
| -03 | DN65 | 6-40 | 76,10 | 125,00 | 12,00 | 106,00 | 2,90 | 2,90 | 82,10 | 13,00 | 3,53 | 8 |
| -04 | DN50 | 6-100 | 60,30 | 112,00 | 12,00 | 91,00 | 3,20 | 3,20 | 66,27 | 13,00 | 3,53 | 8 |
| -05 | DN40 | 6-100 | 48,30 | 95,00 | 12,00 | 77,00 | 2,90 | 2,90 | 53,57 | 11,00 | 3,53 | 8 |
| -06 | DN32 | 6-100 | 42,40 | 93,00 | 10,00 | 72,00 | 2,60 | 2,60 | 47,22 | 13,00 | 3,53 | 4 |
| -07 | DN25 | 6-100 | 33,70 | 84,00 | 10,00 | 63,00 | 2,60 | 2,60 | 40,87 | 13,00 | 3,53 | 4 |
| -08 | DN20 | 6-100 | 26,90 | 71,00 | 10,00 | 53,00 | 2,30 | 2,30 | 31,35 | 11,00 | 3,53 | 4 |
| -09 | DN15 | 6-100 | 21,30 | 66,00 | 10,00 | 48,00 | 2,00 | 2,00 | 26,57 | 11,00 | 3,53 | 4 |
| -10 | DN10 | 6-100 | 17,20 | 62,00 | 10,00 | 44,00 | 1,80 | 1,80 | 23,39 | 11,00 | 3,53 | 4 |
| -11 | DN150 | 25-100 | 168,30 | 250,00 | 22,00 | 217,00 | 7,10 | 3,20 | 177,40 | 21,00 | 3,53 | 12 |

Angle pitch on bolt hole: 360° divided with No. of bolt holes $\pm 0,2^\circ$
O-ring track dimensions $d4=d0+0,2\text{mm}$, $d5=d3-0,7\text{mm}$, $d6=d3+0,1$

NOTE 1: MARKING REQUIRED ARE: [SUPPLIER NAME][ITEM NBR][DWG NBR + REVISION]
[STANDARD][MATERIAL TYPE][NOMINAL PRESSURE (PN)]

| | | | | | | | |
|---|---------|-------------|------------------------------|--|-----------------------------|-------|------------|
| Drawn | Checked | Approved | Created Date | General geometrical tolerancing (ISO 2768) | General surface finish (Ra) | Scale | Paper size |
| miguser | PDM | PDM | 2015-02-09 | m | 3.2 | - | A3 |
|  | | | Title | | | | |
| A DOVER COMPANY | | | COMPACT WELDING NECK FLANGES | | | | |
| Article number | | Design Type | Drawing number | | Revision | Sheet | |
| | | CD | CD000219 | | 13 | 1 (2) | |

Company Confidential, Property of SWEF International AB