

41A233999

CONT ON SHEET SH NO.

REV NO.  
CONT ON SHEET SH NO.

TITLE  
**BARREL (ROTOR YOKE)**  
FIRST MADE FOR **ALTERNATOR GTA-11A1 79557**

PT	NAME	DWGN#	DESCR.	MAT'L
1	BARREL		FORGING	(SEE NOTE)

F.C.F.

THESE DIA'S TO BE CONCENTRIC WITHIN .010 T.I.R.

THESE DIA'S TO BE CONCENTRIC WITHIN .030 T.I.R.

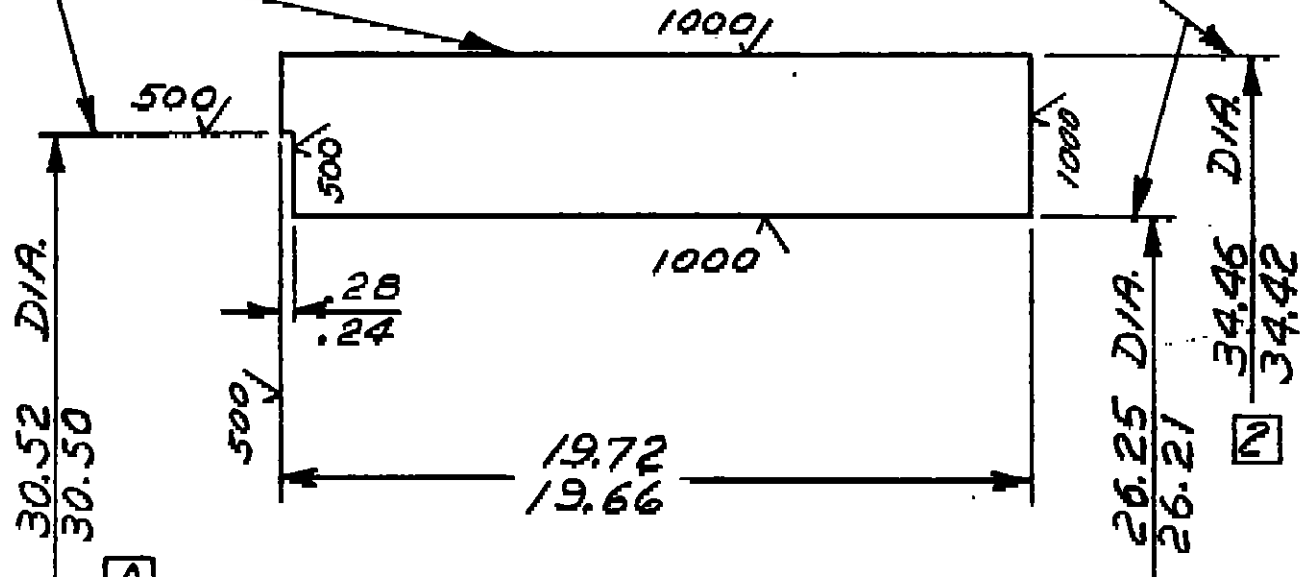

**1** MATERIAL: - B405A2 STL. EXCEPT .33 -.38 CARBON  
63000 P.S.I. TENSILE MIN.  
42000 P.S.I. YIELD MIN.

**1** TEST TO BE MADE FROM A HAMMERED TEST BAR  
PURCHASE FROM: EDGEWATER STEEL CO.  
PITTSBURGH, PA. OR EQUIV.

UNLESS OTHERWISE SPECIFIED USE	-APPLIED PRACTICES	SURFACES	TOLERANCES ON MACHINED DIMENSIONS		
			FRACTIONS	DECIMALS	ANGLES
	ST0006 S012	✓	+	+	+

**B**  
**2** MAKE FROM 41A233999P1  
SHOT BLAST TO REMOVE OIL,  
DIRT, GREASE, PAINT,  
VARNISH AND SCALE

NOTE: UG 3D MODEL EXISTS FOR P1 AND P2

REVISIONS		PRINTS TO	
1	FOR 21/12/68 68162		6001 PUNCH PEBE
2	FOR 10/1/69 68597		
A	FOR 10/1/69 68599		
B	03/03/03 N.KUMAR C.FOX CO-081483 ADD P2		

MADE BY <i>A.D. Nema</i> Sep 7, 1967	APPROVAL <i>T.S.D.</i> 9-7-67	DIV OR DEPT. <b>ERIE</b>	41A233999
DRAWN BY <i>J. Welther</i> SEP 7, 1967		LOCATION <b>RY</b>	CONT ON SHEET SH NO.